

FMP-60

(1/2)

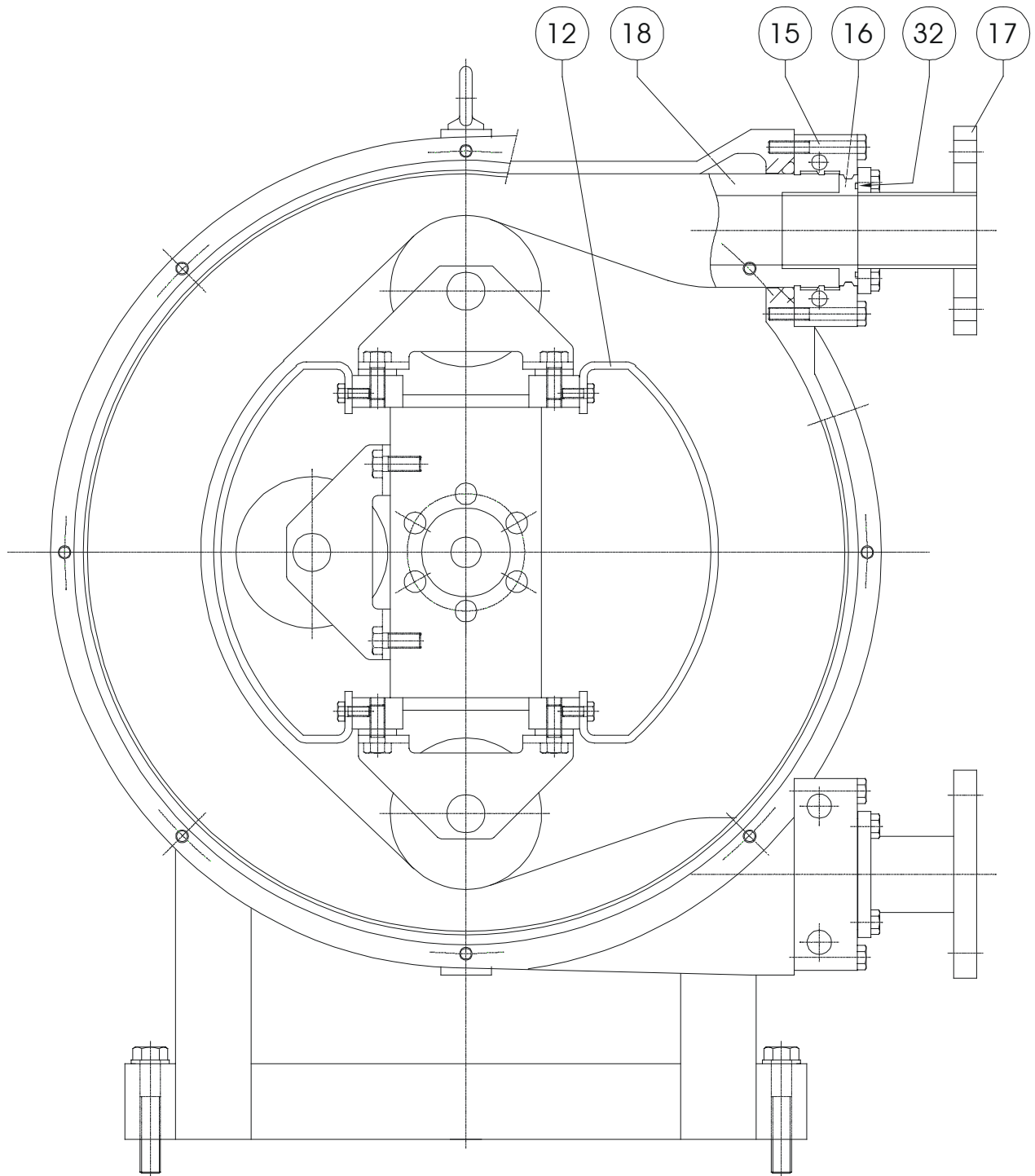

FMP-60

(2/2)

FMP-60

Nº	DESCRIPTION	QTY	CODE	MATERIAL
1	Pump Housing	1	110.00.01	Cast Iron – Powder Epoxy Coated
3	Bearing Housing	1	110.00.03	Cast Iron
4	Rotor Shaft	1	110.00.04	Carbon Steel
5	Rotor	1	110.00.05	Cast Iron
6	Roller support	2	110.00.06	Carbon Steel
7	Shim	2	110.00.07	Carbon Steel
8	Shaft screw	2	110.00.08	
9	Roller shaft	2	110.00.09	Carbon Steel
10	Separator	4	110.00.10	Carbon Steel
11	Roller	2	110.00.11	Anodized Steel
12	Lateral rotor	2	110.00.12	Carbon Steel
13	O-ring cover	1	110.00.13	
14	Front cover transparent	1	110.00.14	
15	Press flange	2	110.00.15	Anodized Steel
16	Insert – Stainless Steel	2	110.00.16	316 Stainless Steel
	Insert – Polypropylene	2	110.00.46	Polypropylene
	Insert - PVDF	2	110.00.47	PVDF
17	Connection flange 150 lb.	2	110.00.17	Carbon Steel - Anodized
	Connection flange 150 lb.	2	110.00.45	Carbon Steel – Halar Coated
	Connection Sanitary Tri-Clamp	2	110.00.42	316 Stainless Steel
18*	Hose NR	1	110.00.18	Natural Rubber
	Hose NR-A	1	110.00.19	Natural Rubber – Food Grade
	Hose NBR	1	110.00.20	Buna N
	Hose NBR-A	1	110.00.21	Buna N – Food Grade
	Hose EPDM	1	110.00.22	EPDM (Nordel)
19	Bearing box cap	1	110.00.23	
20	Base	1	110.00.24	
21	Stud	2	110.00.25	
26	Front Bearing (Rotor)	1	110.00.26	
27	Rear Bearing (Rotor)	1	110.00.27	
28	Roller ball bearing	4	110.00.28	
29	Elastic o-ring for shaft	1	110.00.29	
30	Lip Seal (Bearing Housing)	1	110.00.30	
31	Lip Seal (Roller)	1	110.00.31	
32	O-ring connection	2	110.00.32BN	Buna N
34	O-ring (Cover)	1	110.00.33	
35	Eye bolt	1	110.00.34	
36	Nut	2	110.00.35	
37	Nut	2	110.00.36	
	Check Valve	1	110.00.53	
*	Food Grade Silicon Grease	1	106.00.41	